

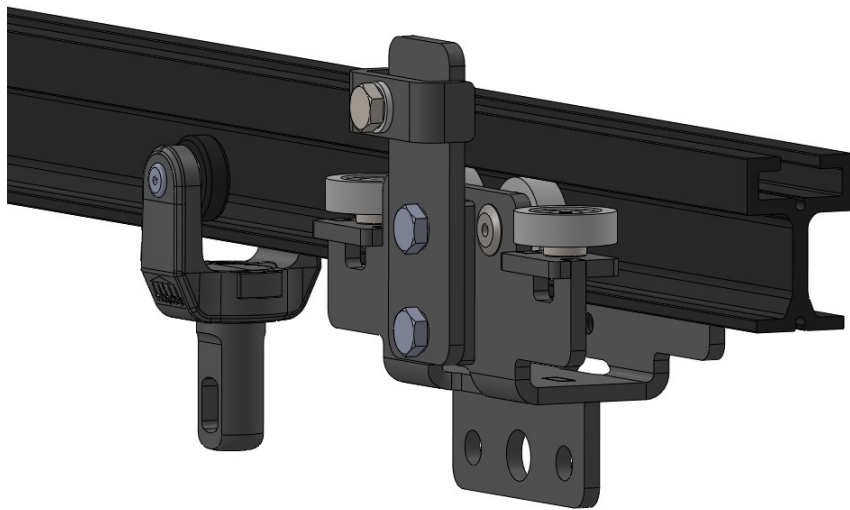

TRX SYSTEM

DATASHEET



EDITION: 2022 - REVIEW: 05

© 2022 - PERONI S.P.A.

All rights reserved.

The information and illustrations contained in this document may not be used, published or redistributed in any form without the prior written consent of Peroni S.p.A.

Subject to technical modifications without prior notice and errors excepted.
Illustrations of the product in this manual may differ from the actual product.

The colour of technical drawings is for illustration purposes only.

NOTE:

All units are in millimeters unless otherwise indicated.

INTRODUCTION

TRX is a professional modular system for the horizontal handling of medium-weight stage curtains. Designed mainly for wipe and traveler curtains, TRX is the perfect solution for stages, studios, trade fairs, conference hall, etc.

KEY FEATURES

VERSATILITY

WIDE RANGE OF CONFIGURATIONS AND CUSTOMIZED SOLUTIONS.

TRX is extremely versatile thanks to its unique profile and extensive range of components. Various straight and curved configurations with single or double rail are allowed.

The system's support beam consists in an extruded aluminium profile which is light and compact, but at the same time solid.

According to your needs, profiles can also be curved with a minimum curve radius of 500mm.

On top of the existing configurations and depending on specific applications, customized solutions can be developed to suit particular needs.

QUICK ASSEMBLY

FAST, EASY AND EXTREMELY PRECISE ASSEMBLY.

The T-channel in the upper part of the profile and two round slots, combined with the use of special connectors, create precise sturdy joints between track sections and ensure correct alignment of the surfaces.

All TRX components are equipped with special swivel nuts, to be easily and quickly fasten into the track's T-channel. This feature enables components to be moved and positioned to any point along the rail with a simple hex key, reducing assembly time on site.

FIXING OPTIONS

SUSPENDING ACCESSORIES ALLOW AN EASY INSTALLATION.

TRX system comprises a wide range of suspending accessories designed to accommodate most common conditions of installation:

- Flying bar systems (hook clamp or pipe collar),
- Girder (girded clamp),
- Wall mounting (wall bracket),
- Ceiling mounting (studding bar),
- Ropes/wires suspension (lifting eyebolt).

OPERATING PRINCIPLE

FROM WALK-ALONG TO CORDED SOLUTIONS

TRX system can operate in different ways manually (with or without an operating line) or via motorized drive.

- Walk-along system: operated manually, simply by pulling one edge of the curtain
- Corded manual system: an hauling line is operated manually by using an adjustable floor pulley or a hand winch
- Corded motorized system: the hauling line is operated by using an electric drive system

COLOUR/SURFACE FINISH



MATT BLACK SIGNATURE

All main components are matt black finished to reduce light reflection on stage. The aluminium profile is black anodized and all steel parts are black powder-coated.

Personalized finishes can be available upon request.

1 · TECHNICAL DATA

5.1 · TRACK LOAD CAPACITY

Span [cm]	 Centre Point Load [kg]	 Uniformly Distributed Load	
		Total Load [kg]	Load per meter [kg/m]
100	64	70	70
150	39	53	35
200	15	25	13

The values shown in the table are the maximum allowable loads that can be applied to the track. When calculating the allowable loads shown in the table, it is assumed that the track is simply supported at the end connection. The self weight of the track, static and dynamic forces have been taken into account when calculating the values in the table. It should be noted that this are idealised loading condition.

5.2 · COMPONENTS LOAD CAPACITY

Art.	Description	WLL Working Load Limit [kg]
1T10	Master Carrier	30
1T11	Master Carrier - side cord operation	30
1T12	Master Carrier - top cord operation	30
1T13	2-Wheel Runner	10
1T30	Side Cord Suspension Bracket	65
1T31	Top Cord Suspension Bracket	65
1T34	Hook Clamp	40
1T35	Hook Clamp with Channel Nut	40
1T36	Studding Bar with Pipe Collar	85

The track, the carriers and all suspending components are load bearing elements of the system and as such are tested and rated to provide a 3:1 safety factor if used as instructed by this manual.

2 · COMPONENTS AND ACCESSORIES

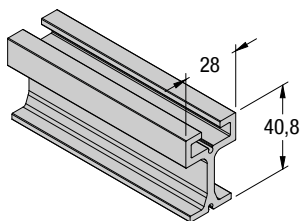

1T01 · STRAIGHT TRACK

INFO

WEIGHT – 946 g/m
 MAX BAR LENGTH – 600 cm
 MAX SPAN – 200 cm
 MINIMUM CURVE RADIUS – 50 cm

FEATURES

- Extruded aluminium profile, black anodized
- 'T' channel on top to fix the components
- Two aligning slots to ensure a perfect joint

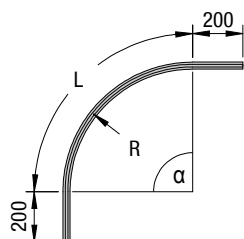

1T01C · CURVED TRACK

INFO

1T01C-050	90° Curved Track
1T01C-075	90° Curved Track
1T01C-100	90° Curved Track
1T01C-XXX	Custom Curved Track

R

50 cm

L

78,5 cm

WEIGHT

1.1 kg

FEATURES

- Curved extruded aluminium profile
- 200 mm straight ends

1T01C-S · CURVED TRACK FOR OVERLAP SECTION

INFO

TOTAL LENGTH – 200 cm
 OVERLAP LENGTH – 100 cm
 OFFSET – 50 mm
 WEIGHT – 1.9 kg

FEATURES

- Extruded aluminium profile, curve and reverse curve for overlap section
- Normally used in pairs with 1T04 Overlap Bridge to keep distance and rigidity



1T02 · CONNECTION SET

INFO

COLOUR – Zinc plated
 WEIGHT – 135 g

FEATURES

- 4 x M8 socket set screw
- 2 aligning pins (also available as spare parts)

FUNCTION

- Connect and align two sections of track together

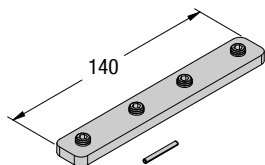

1T02T · CONNECTION SET

INFO

COLOUR – Matt black
 WEIGHT – 285 g

FEATURES

- 2 plates (inner and outer)
- 4 x M8 countersunk head cap screw
- 2 aligning pins (also available as spare parts)

FUNCTION

- Connect and align two sections of track together
- Recommended for touring (frequent demounting)

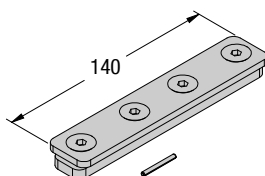

1T03 · END STOP

INFO

COLOUR – Matt black
 WEIGHT – 120 g

FEATURES

- 12mm ø anchorage hole
- Rubber damper block to reduce impact noise
- Channel Nut included

FUNCTION

- Stop the carriers at the end of the track
- Provide an anchor point to fix the outer edge of a curtain (off-stage)

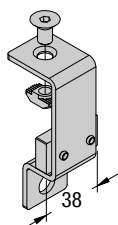

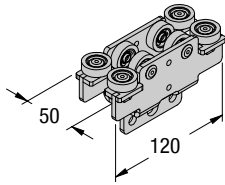

1T10 · MASTER CARRIER

INFO

COLOUR – Matt black
WEIGHT – 478 g
WLL – 30 kg

FEATURES

- 8 ball bearing plastic wheels
- Rubber damper blocks

FUNCTION

- Leading carrier for walk-along curtain

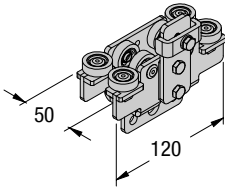

1T11 · MASTER CARRIER FOR SIDE CORD OPERATION

INFO

COLOUR – Matt black
WEIGHT – 625 g
WLL – 30 kg

FEATURES

- 8 ball bearing plastic wheels
- Rubber damper blocks
- Side arm with rope clamp

FUNCTION

- Leading carrier for side cord configuration

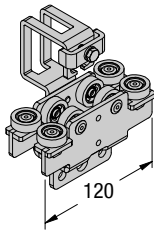

1T12 · MASTER CARRIER FOR TOP CORD OPERATION

INFO

COLOUR – Matt black
WEIGHT – 660 g
WLL – 30 kg

FEATURES

- 8 ball bearing plastic wheels
- Rubber damper blocks
- 'C' shaped arm with rope clamp

FUNCTION

- Leading carrier for top cord configuration

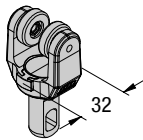

1T13 · 2-WHEEL RUNNER

INFO

COLOUR – Matt black
WEIGHT – 33 g
WLL – 10 kg

FEATURES

- 2 ball bearing plastic wheels
- Rubber damper blocks
- Swivel attachment

FUNCTION

- Sliding carrier

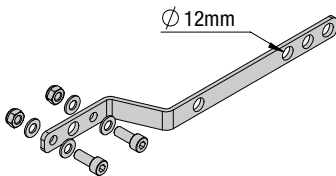

1T14 · OVERLAP ARMS KIT

INFO

COLOUR – Matt black
WEIGHT – 194 g

FEATURES

- Overlap arms (2 pcs) for Master Carriers
- Screws, washers and nut included

FUNCTION

- Create a 50cm overlap on mono-rail configuration, normally used in pairs

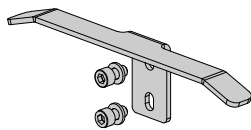

1T15 · LIMIT SWITCH ARM

INFO

COLOUR – Matt black
WEIGHT – 112 g

FEATURES

- Screws and washers included

FUNCTION

- Limit switch arm for side cord motorized system
- For use in combination with 1T11 and 1T50

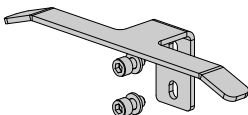

1T16 · LIMIT SWITCH ARM

INFO

COLOUR – Matt black
WEIGHT – 127 g

FEATURES

- Screws and washers included

FUNCTION

- Limit switch arm for top cord motorized system
- For use combination with 1T12, 1T52, 1T53

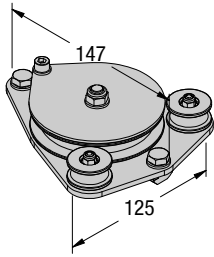

1T20 · RETURN PULLEY

INFO	FEATURES	FUNCTION
COLOUR – Matt black WEIGHT – 685 g	<ul style="list-style-type: none"> · 1 diverting sheave with ball bearings · 2 guiding sheaves with ball bearings · For 8mm \emptyset rope · 2 Channel Nuts included 	<ul style="list-style-type: none"> · Return the operating line back to the head double pulley

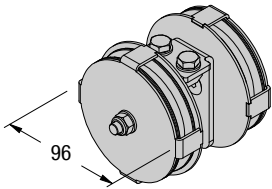

1T21 · HEAD DOUBLE PULLEY

INFO	FEATURES	FUNCTION
COLOUR – Matt black WEIGHT – 705 g	<ul style="list-style-type: none"> · 2 diverting sheaves with ball bearings · For 8mm \emptyset rope · 2 Channel Nuts included 	<ul style="list-style-type: none"> · Divert 90° the operating lines

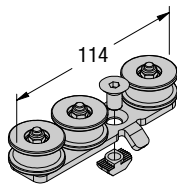

1T22 · TOP CORD GUIDE

INFO	FEATURES	FUNCTION
COLOUR – Matt black WEIGHT – 155 g	<ul style="list-style-type: none"> · 3 guiding sheaves with ball bearings · For 8mm \emptyset rope · Channel Nut included 	<ul style="list-style-type: none"> · Guide and support the rope along the top of the track · For curved track and for double track configuration (offset overlap)

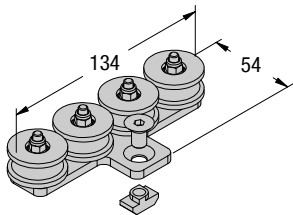

1T23 · HEAD PULLEY CORD ALIGNER

INFO	FEATURES	FUNCTION
COLOUR – Matt black WEIGHT – 247 g	<ul style="list-style-type: none"> · 4 guiding sheaves with ball bearings · For 8mm \emptyset rope · Channel Nut included 	<ul style="list-style-type: none"> · Align the operating rope to the 1T21 Head Double Pulley

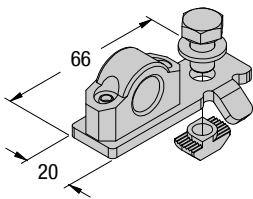

1T24 · SIDE CORD SUPPORT

INFO	FEATURES	FUNCTION
COLOUR – Matt black WEIGHT – 65 g	<ul style="list-style-type: none"> · For 8mm \emptyset rope · Channel Nut included · Low friction plastic guide 	<ul style="list-style-type: none"> · Guide and prevent the returning rope from sagging down · Only on straight tracks

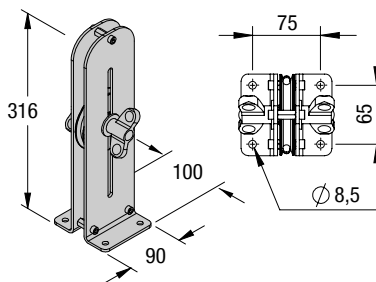

1Z01 · ADJUSTABLE FLOOR PULLEY

INFO	FEATURES	FUNCTION
COLOUR – Matt black WEIGHT – 2,1 kg EXCURSION – 200 mm	<ul style="list-style-type: none"> · For 8mm \emptyset rope · 2 wing knobs for quick adjustments · 4 holes to fix the pulley to the floor (ground fixing fasteners non included) 	<ul style="list-style-type: none"> · Manually operate the hauling line of corded systems · Adjust the rope tension

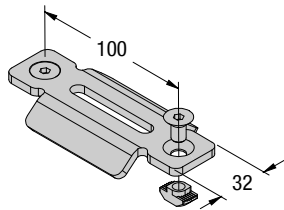

1T04 · OVERLAP BRIDGE

INFO	FEATURES	FUNCTION
COLOUR – Matt black WEIGHT – 250 g WLL – 80 kg	<ul style="list-style-type: none"> · Overlap steel plate · 2 Channel Nuts included 	<ul style="list-style-type: none"> · Create a rigid track overlap · Join and ensure parallelism between two track sections

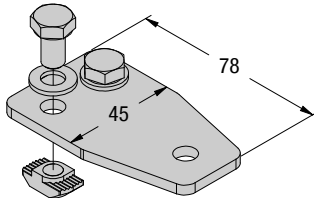

1T05 · OFFSET PLATE

INFO	FEATURES	FUNCTION
COLOUR – Matt black WEIGHT – 125 g	<ul style="list-style-type: none"> · Offset steel plate (50mm offset) · 2 Channel Nuts included 	<ul style="list-style-type: none"> · Fixing point, centred to the system, for the suspension of double track · In combination with 1T34 Hook Clamp

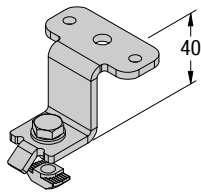

1T30 · SIDE CORD SUSPENSION BRACKET

INFO	FEATURES	FUNCTION
COLOUR – Matt black WEIGHT – 115 g WLL – 65 kg	<ul style="list-style-type: none"> · Channel Nut included 	<ul style="list-style-type: none"> · Attach straight track sections directly to the ceiling or to other suspension accessories · For side cord hauling system

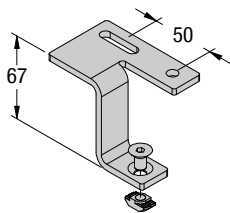

1T31 · TOP CORD SUSPENSION BRACKET

INFO	FEATURES	FUNCTION
COLOUR – Matt black WEIGHT – 225 g WLL – 65 kg	<ul style="list-style-type: none"> · Offset plate · Channel Nut included 	<ul style="list-style-type: none"> · Attach track sections directly to the ceiling or other suspension accessories · For top cord hauling system

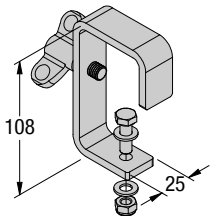

1T34 · HOOK CLAMP

INFO	FEATURES	FUNCTION
COLOUR – Matt black WEIGHT – 310 g WLL – 40 kg	<ul style="list-style-type: none"> · For 50mm ø tube/truss · Suspension kit · Screw, two washers and selflocking nut included 	Attach track section in combination with different accessories: <ul style="list-style-type: none"> · 1T04 Overlap Bridge · 1T05 Offset Plate · 1T30 Suspension Bracket · 1T31 Suspension Bracket

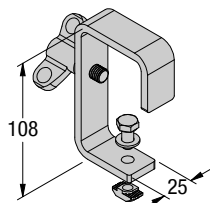

1T35 · HOOK CLAMP WITH CHANNEL NUT

INFO	FEATURES	FUNCTION
COLOUR – Matt black WEIGHT – 316 g WLL – 40 kg	<ul style="list-style-type: none"> · For 50mm ø tube/truss · Screw, washer and channel nut included 	<ul style="list-style-type: none"> · Attach straight and/or curved track section directly to a tube or truss

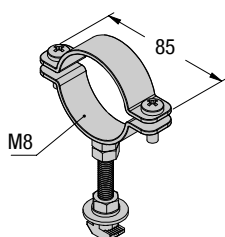

1T36 · PIPE COLLAR

INFO	FEATURES	FUNCTION
COLOUR – Zinc plated WEIGHT – 126 g WLL – 95 kg	<ul style="list-style-type: none"> · For 50mm ø tube/truss · M8 threaded rod with Channel Nut and Pipe collar · Washer and nuts included 	<ul style="list-style-type: none"> · Low-clearance alternative to 1T35 for side corded track · Attach track sections directly to tube or truss · Only for side cord operation and for monorail walk-along system

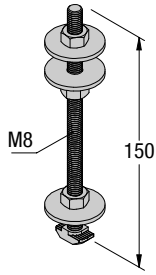

1T37 · M8 STUDDING BAR

INFO	FEATURES	FUNCTION
COLOUR – Zinc plated LENGTH – 150 mm WEIGHT – 106 g	<ul style="list-style-type: none"> M8 threaded rod with channel nut, washers and nuts 	<ul style="list-style-type: none"> Anchorage point for track Adjustable distance Other lengths available on request

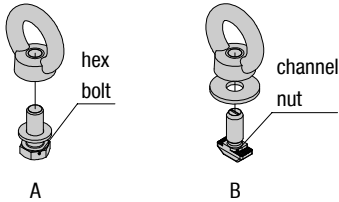

1T38 · EYENUT

INFO	FEATURES	FUNCTION
COLOUR – Zinc plated WEIGHT – 70 g WLL – 95 kg	<ul style="list-style-type: none"> Hex bolt (A config) for 1T30 or 1T31 Nut (B config) for direct track fixing 	<ul style="list-style-type: none"> To lift and suspend track sections by cordage/wire rope

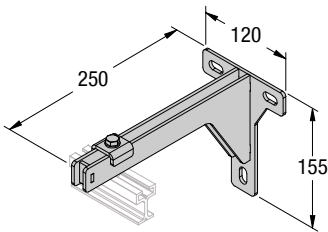

1Z10 · WALL BRACKET 250 mm

INFO	FEATURES	FUNCTION
LENGTH – 250 mm COLOUR – Matt black WEIGHT – 950 g WLL – 50 kg	<ul style="list-style-type: none"> 3 slots for M10 fasteners Wall fixing fasteners non included 	<ul style="list-style-type: none"> Used to attach a track to a wall Adjustable wall distance Tested for 50 kg, safety factor 5:1

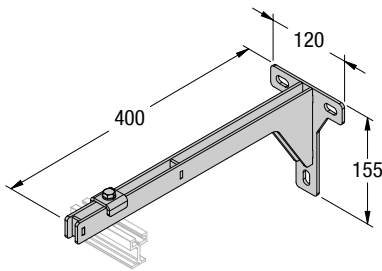

1Z10 · WALL BRACKET 400 mm

INFO	FEATURES	FUNCTION
LENGTH – 400 mm COLOUR – Matt black WEIGHT – 1.250 g WLL – 30 kg	<ul style="list-style-type: none"> 3 slots for M10 fasteners Wall fixing fasteners non included 	<ul style="list-style-type: none"> Used to attach a track to a wall Adjustable wall distance Tested for 30 kg, safety factor 5:1



3E8 · POLYESTER ROPE

INFO	FEATURES	FUNCTION
COLOUR – Matt black WEIGHT – 50 g/m REEL LENGTH – 200 m	<ul style="list-style-type: none"> 8 mm diameter 100% fiber of high tenacity polyester Available in reel or in cut lengths 	<ul style="list-style-type: none"> Operating rope for manual or motorized system

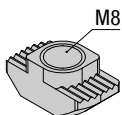

1TXR · CHANNEL NUT

INFO	FEATURES	FUNCTION
COLOUR – Zinc plated WEIGHT – 6 g	<ul style="list-style-type: none"> 90° rotating slider M8 threaded hole 	<ul style="list-style-type: none"> Used to fix all components into the T-channel of the track Pre-assembled on components or available as spare item

3 · DRIVE SYSTEMS

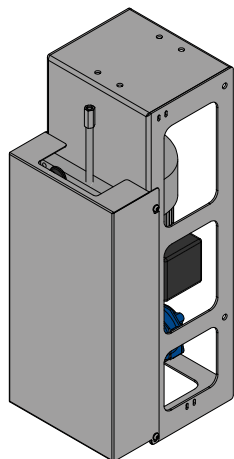

2DR1 · MOTOR UNIT

INFO

COLOUR – Matt black
 WEIGHT – 17,5 kg
 DIMENSIONS (W x H x D) – 236 x 200 x 560 mm

POWER – 0,37 kW
 TORQUE – 22 Nm
 VOLTAGE – 3x230/400 VAC
 FREQUENCY – 50 Hz
 MAX SPEED – 0,95 m/s
 MAX CURTAIN WEIGHT – 300 kg (straight layout), 200 kg (curved layout)

CONNECTORS

- 1 connector for the extension cable
- 2 connectors for the limit switches

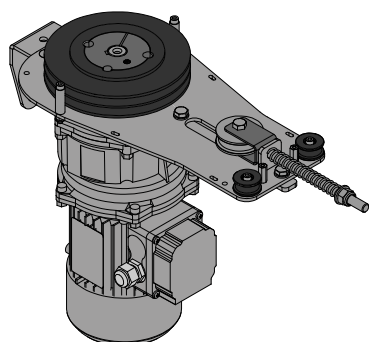

2DR2 · MOTOR UNIT

INFO

COLOUR – Matt black
 WEIGHT – 13,5 kg
 DIMENSIONS (W x H x D) – 385 x 180 x 337 mm

POWER – 0,18 kW
 TORQUE – 20 Nm
 VOLTAGE – 3 x 230/400 VAC
 FREQUENCY – 50 Hz
 MAX SPEED – 0,60 m/s
 MAX CURTAIN WEIGHT – 125 kg (straight layout), 100 kg (curved layout)

CONNECTORS

- 1 connector for the extension cable
- 2 connectors for the limit switches

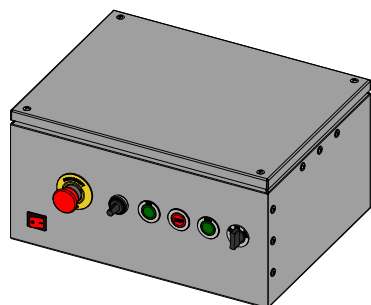

2QE · CONTROL UNIT

MODEL

M230V0-S
 Standard Unit

INFO

DIMENSIONS (W x H x D) - 435 x 225 x 330 mm
 WEIGHT – 12,0 kg
 VOLTAGE – 1 x 230VAC
 FREQUENCY – 50 Hz
 POWER CABLE – 2 m
 PLUG – CEE 7/7

FEATURES

- Open/Stop/Close
- Speed adjustment
- Emergency stop button
- Local/Remote selector
- Remote pendant ready
- Radio control ready

M230V0-D
 DMX Unit

DIMENSIONS (W x H x D) - 435 x 225 x 330 mm
 WEIGHT – 12,0 kg
 VOLTAGE – 1 x 230VAC
 FREQUENCY – 50 Hz
 POWER CABLE - 2 m
 PLUG – CEE 7/7

- Open/Stop/Close
- Speed adjustment
- Emergency stop button
- DMX interface
- Local/Remote/DMX selector
- Remote pendant ready
- Radio control ready

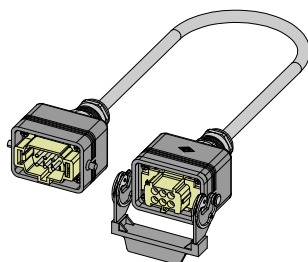

2QEM · EXTENSION CABLE

INFO

COLOUR – Grey
 CABLE - 7G1 mm²

FEATURES

- Connectors on both sides
- Standard length 15 m
- Custom length available on request

FUNCTION

- Power and control cable to connect the motor unit with the control unit

4 · REMOTE CONTROLLER

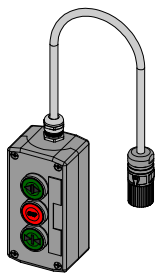

2QER-01 · REMOTE PENDANT

INFO

DIMENSIONS (W x H x D) – 70 x 135 x 63 mm
WEIGHT – 300 g (cable excluded)

FEATURES

- Open/stop/close
- Pre-wired in factory with connector
- 15 m cable
- Custom length available

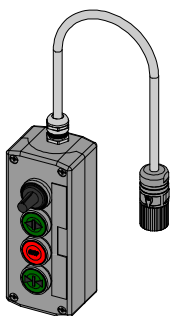

2QER-02 · REMOTE PENDANT WITH SPEED ADJUSTMENT

INFO

DIMENSIONS (W x H x D) – 70 x 166 x 63 mm
WEIGHT – 380 g (cable excluded)

FEATURES

- Open/stop/close
- Potentiometer (speed adjustment)
- Pre-wired in factory with connector
- 15 m cable
- Custom length available on request

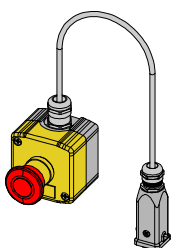

2QER-ESB · EMERGENCY STOP BUTTON

INFO

DIMENSIONS (W x H x D) – 67 x 67 x 92 mm
WEIGHT – 185 g (cable excluded)

FEATURES

- Remote emergency stop button for DMX
- 25 m cable
- Custom length available on request

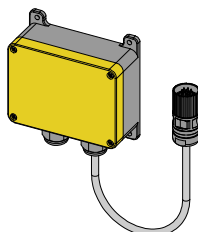

2RCR · RADIO CONTROL RECEIVER

INFO

DIMENSIONS (W x H x D) – 120 x 116 x 50 mm
WEIGHT – 315 g (cable excluded)

FEATURES

- Voltage 12/24 VDC
- Frequency 2,4 GHz, 16 channels
- IP66
- Wired in factory with connector for 2QE



2RCT · RADIO CONTROL TRANSMITTER

INFO

DIMENSIONS (W x H x D) – 65 x 112 x 35 mm
WEIGHT – 130 g

FEATURES

- Frequency 2,4 GHz, 16 channels
- IP65
- Open/stop/close buttons
- ON/OFF switch
- Battery: 2 x 1,5V AAA / LR03

5 · LIMIT SWITCHES

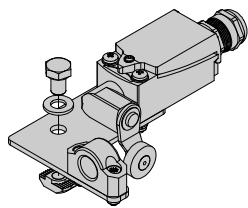

1T50 · LIMIT SWITCH

INFO	FEATURES	FUNCTION
<p>COLOUR – Matt black WEIGHT – 280 g (cable excluded)</p>	<ul style="list-style-type: none"> · Track mounting plate · Limit switch with cable and connector included · Pre-wired in factory 	<ul style="list-style-type: none"> · For side cord operation · In combination with 1T11 and 1T15

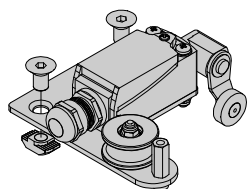

1T52 · LIMIT SWITCH WITH PULLEY

INFO	FEATURES	FUNCTION
<p>COLOUR – Matt black WEIGHT – 350 g (cable excluded)</p>	<ul style="list-style-type: none"> · Track mounting plate with guiding pulley · Limit switch with cable and connector included · Pre-wired in factory 	<ul style="list-style-type: none"> · For top cord operation · In combination with 1T12 and 1T16

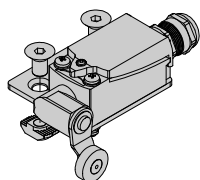

1T53 · LIMIT SWITCH

INFO	FEATURES	FUNCTION
<p>COLOUR – Matt black WEIGHT – 265 g (cable excluded)</p>	<ul style="list-style-type: none"> · Track mounting plate · Limit switch with cable and connector included · Pre-wired in factory 	<ul style="list-style-type: none"> · For top cord operation · In combination with 1T12 and 1T16



For more technical support,
please contact our corporate offices.

PERONI S.P.A.
Via Monte Leone, 93
21013 Gallarate (VA) Italy
Tel. +39 0331 756 811
email: info@peroni.com
www.peroni.com